



## Hood Latch Panel (76.16.22)

### Removal

#### NOTE :

If the hood latch panel coating is damaged or scratched, it must be repaired using the approved coating.

- 1 . Disconnect the battery ground cable. For additional information, refer to [Specifications](#) (Section 414-00)
- 2 . Remove the front bumper. For additional information, refer to [Front Bumper \(76.22.49\)](#) (Section 501-19)
- 3 . Release the power steering fluid reservoir and position aside.

► Release the clip.

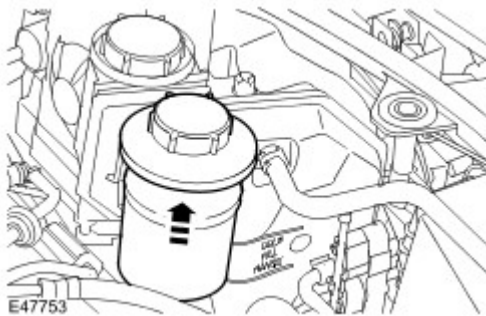

- 4 . Release the washer reservoir filler neck from the coolant tank clip.
- 5 . Remove the 2 coolant expansion tank mounting bolts.
- 6 . Release the coolant expansion tank.

► Lift coolant expansion tank vertically.

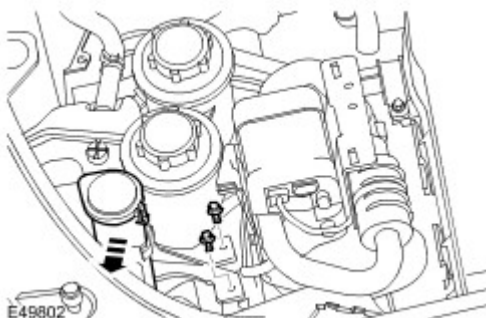

- 7 . Remove the radiator securing pegs.

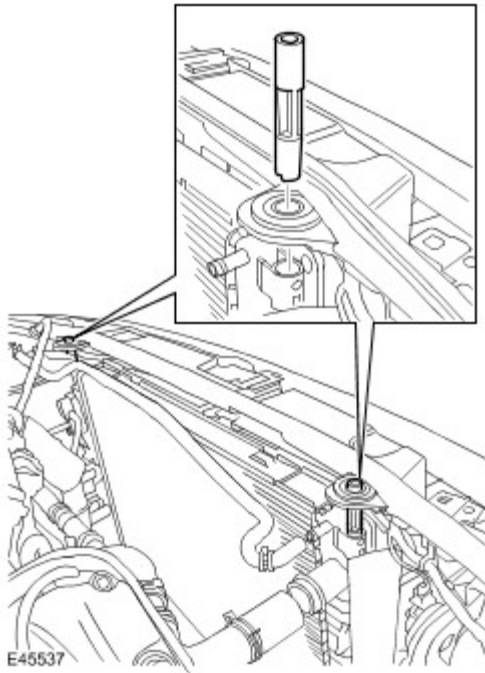

- 8 . Disconnect the hood release cable from the connecting box.

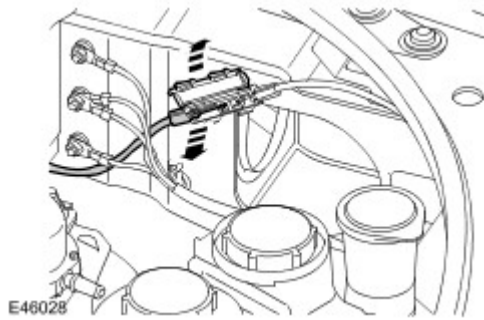

- 9 . **NOTE :**  
Note the fitted position.  
Release the wiring harness.
- Disconnect the 3 electrical connectors.
  - Release the 9 clips.
  - Release the grommet.
  - Carefully tie the harness aside.

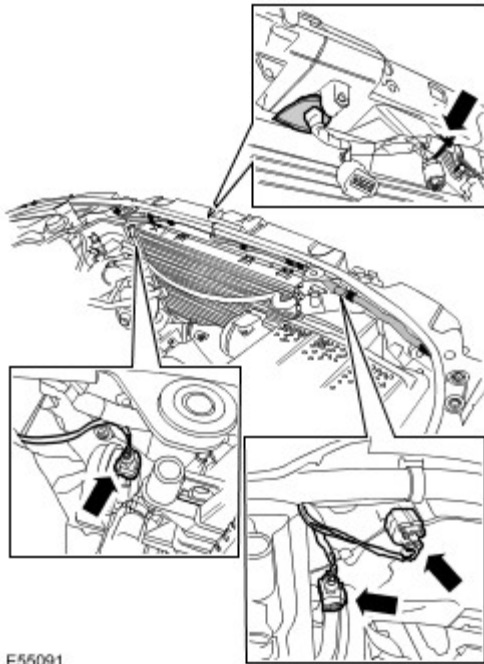

- 10 . Remove the panel upper fixings.  
▶ Remove the 4 Torx bolts.

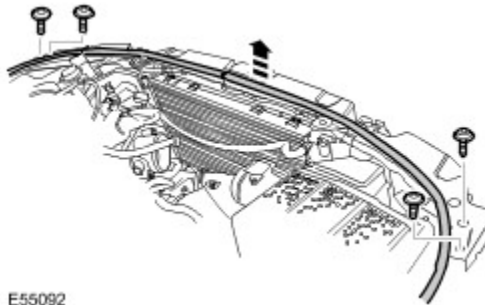

- 11 . Remove the panel lower fixings.  
▶ Remove the 6 Torx bolts.

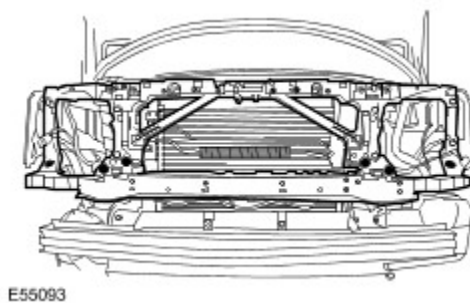

- 12 . **NOTE :**  
Note the fitted position.  
With assistance, remove the hood latch panel.

- 13 . Noting the fitted position, remove the 6 spacers.

➤ Remove the 2 clips.

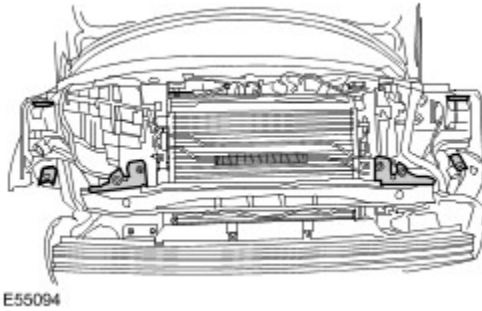

- 14 . **NOTE :**

Do not disassemble further if the component is removed for access only.

Remove the 2 horn assemblies.

➤ Remove the 2 air deflectors.

➤ Remove the 2 Torx bolts.

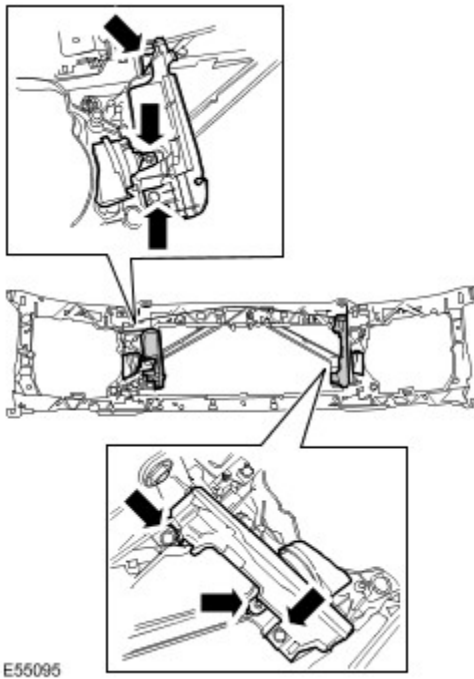

- 15 . Remove the hood switch.

➤ Remove the 2 Torx bolts.

➤ Release the 2 clips.

- 16 . Remove the RH hood latch.

➤ Release and remove the cable.

- 17 . Remove the LH hood latch.

➤ Remove the 2 Torx bolts.

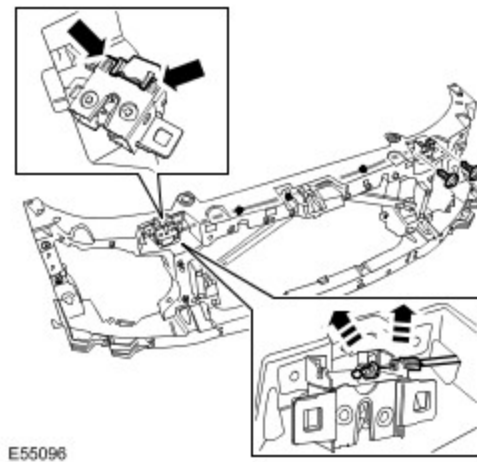

## Installation

- 1 . Install the horn assemblies.
  - Install the air deflectors.
  - Install the bolts and tighten to 10 Nm (7 lb.ft).
- 2 . Install the LH hood latch.
  - Tighten the Torx bolts to 10 Nm (7 lb.ft).
- 3 . Install the RH hood latch.
  - Attach the hood release cable.
  - Install the hood switch.
  - Tighten the Torx bolts to 10 Nm (7 lb.ft).
- 4 . Install the spacers.
  - Install the clips.
- 5 . **NOTE :**  
Align to the position noted on removal.  
With assistance, install the hood latch panel.
- 6 . Install the panel fixings.
  - Install and tighten the bolts to 25 Nm (18 lb.ft).
- 7 . **NOTE :**  
Align to the position noted on removal.  
Install the wiring harness.
  - Connect and secure the electrical connector.
  - Carefully secure the clips.
- 8 .

- Connect the hood release cable.
- 9 . Install the radiator securing pegs.
  - 10 . Install the coolant expansion tank.
    - Position the coolant expansion tank, locate the spigot and lug.
    - Install the bolts and tighten to 10 Nm (7 lb.ft).
  - 11 . Install the windshield washer reservoir filler neck.
    - Locate in clip.
  - 12 . Install the power steering fluid reservoir.
    - Position and secure to mounting bracket.
  - 13 . Install the front bumper. For additional information, refer to [Front Bumper \(76.22.49\)](#) (Section 501-19)
  - 14 . Open and close the hood to check the hood latch operation.
  - 15 . Adjust both of the hood latches.
    - Loosen the 4 hood latch Torx bolts.
    - Lower the hood and check for alignment.
    - Open the hood and tighten the Torx bolts to 10 Nm (7 lb.ft).
    - Check for the correct operation of the hood safety catch.
    - If necessary, repeat the above adjustment procedure.
  - 16 . Connect the battery ground cable. For additional information, refer to [Specifications](#) (Section 414-00)